

Welcome

Hello, welcome to a world where choosing colour for your home is an enjoyable journey!

My ethos is to align interiors with personal experience, to encourage a dialogue with the space that turns a home into an atmospheric haven — I call this creating an aesthetic narrative.

I am delighted you have reached out. I'd love to share with you a bit about colour consultancy, how I work and how I can help you on your colour journey...



What to expect

- 3 About me
- 4 Colour consultancy
- 6 Brands I work with
- 7 How I work - on aesthetic narratives
- 8 How I work - on reading colour
- 9 International clients
- 10 The process
- 11 What to expect afterwards
- 12 Styling direction
- 13 Some press
- 14 Some testimonials
- 15 Fees
- 16 Contact



About me

I am an experienced and industry - recognised professional, working with the palettes of over 20 brands of breathable and designer paints.

My unique approach combines a sensitive reading of light and colour, with vernacular values, contemporary perspectives and mindfulness for a considered and broad-brush service.

Core to my practice is helping home owners recognise that colour and how we feel are interconnected and key to creating timeless, engaging interiors.

Fiona de Lys

INTERIOR COLOUR SPECIALIST



Colour consultancy

Colour plays an important role in anchoring a room and visual messaging. It is the backdrop to which all else in your home relates, creating atmosphere. Choosing colours is an exciting process but, with so many brands and finishes available, it can become daunting and costly, often resulting in a collage of samples and confusion. A colour consultancy with me will help identify colours to enhance your home, style and mood, with an unbiased and professional, broad-brush approach.

Often, a decoration project is part of a personal change in one's life; no matter how small, there is usually a catalyst. Whatever the reason, introducing new colour harmonies creates visual and experiential benefits for you at home.



Colour consultancy –

– the benefits

- ✔ Provide an enjoyable process looking at the palettes and finishes of paint brands
- ✔ Inform you of how light behaves in your home and how to enhance certain areas
- ✔ Build self confidence in encouraging you to be brave with colour under my guidance
- ✔ Reveal your aesthetic narrative in colour
- ✔ Save money in wasted samples
- ✔ Free up time from experimenting and decision-making
- ✔ Support your ethical and ecological preferences
- ✔ Aid long term, sustainable benefits to you and your home without conforming to trends
- ✔ Leave you feeling informed, excited and stress-free about the process
- ✔ Improve your sense of well-being and enjoyment at home

ARGILE
couleurs de terre

BAUWERK
COLOUR®

 **Benjamin Moore®**

earthborn®
Beautifully different paint

 **EDWARD BULMER**
NATURAL PAINT

eicó

 **FRANCESCA'S PAINTS**
ESTABLISHED IN 1996

PICKLESON

VICTORY
COLOURS
Down to Earth Paints

Brands I work with

When choosing paint brands to use in your home, there are many different factors to consider.

This might be a design-led reason, or an eco-credential preference. Other times, it might be the surface finish and practicality of lifestyle and easy maintenance.

I work to the palettes of over 20 brands considered to be leaders within their area of expertise, including lime, breathable, artisanal, vegan, plant-based, traditional, contemporary and historic; all with stunning palettes.

Together, we will identify what is important to you in colours, finish and lifestyle, to select brands that align with your aesthetic and values.



How I work –

– finding your colour story

When we align interiors with personal experience, we encourage a dialogue with the space that turns a home into an atmospheric haven — I call this creating an Aesthetic Narrative®. As a representation of our values and history, desires and aspirations, this mindful confluence between design, colour and personality is a reflection of your unique style, celebrating identity, memory and emotion.

Gaining an understanding of your Aesthetic Narrative® can help guide colour choices and bring a greater sense of happiness and wellbeing. Together, we can identify yours and harness relevant colours into your home.



...more about how I work – – on reading light

My life-long work in differing disciplines of colour, and research of the trompe l'œil of the Ligurian coastline has enabled me to 'read' colour and light in particular ways; resulting in a multi-disciplined and perceptual approach .

By making observations about vernacular values, natural light movements, exterior influences, light and aspect, proportions, eye-lines, tones and shades of materials and existing decor, I form an impression of how to find the best synergy between what is, what you want and what enhances.

My approach is a delicate balance, drawing on design, psychology, science and nature; the space, the intention of the aesthetic and resulting feeling.

International clients

Working across different time-zones enables me to share the joy of my work with international clients. Zoom sessions are arranged, usually alongside supporting documents such as property floor plans, inspiration images and photos of your home.

Colours are identified using brand colour charts of your preference which are either colour matched by you in your country of residence, or, carefully matched by me to branded, Internationally recognised paints that I hold and work with.

Please enquire for costs based on your requirements.

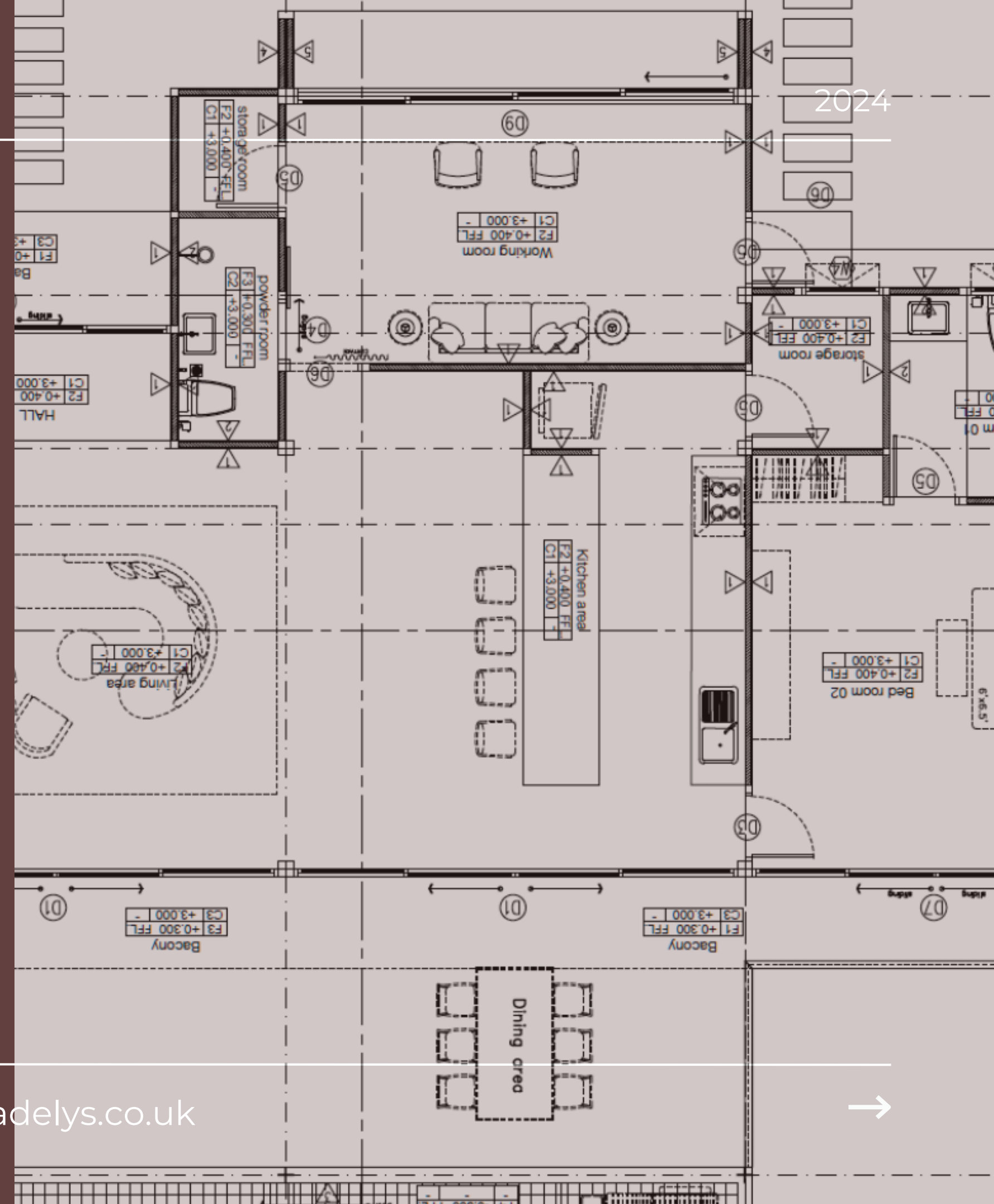

The process



Initial welcome

MEET

Begin your colour journey with a free onboarding zoom where we discuss your goals and I answers any questions you have about the process.

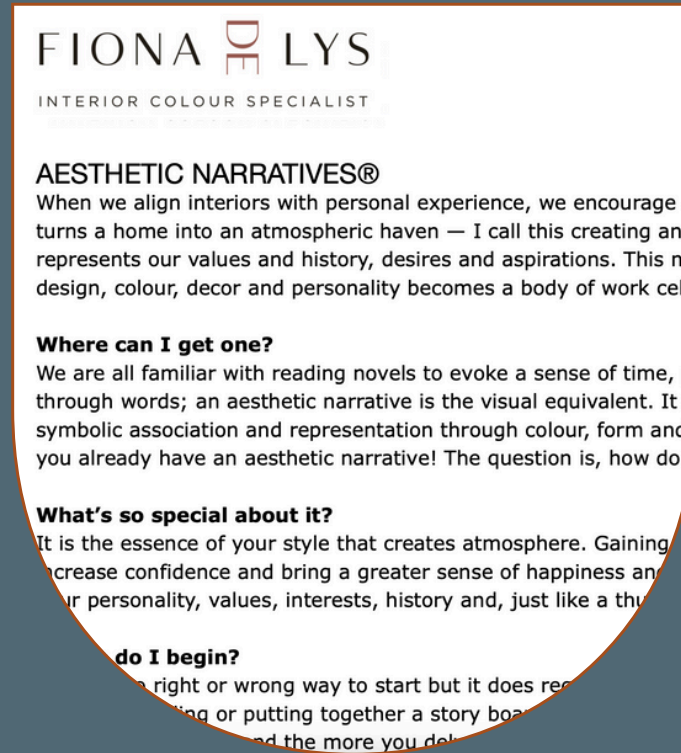

Questionnaire

UNDERSTAND

Explore your Aesthetic Narrative® with my helpful guide, and how it can influence your colour choices and the way you want to feel at home.



Your session

DISCOVER

Watch as we discover colours that enhance your home and mood, creating the space you've been longing for.



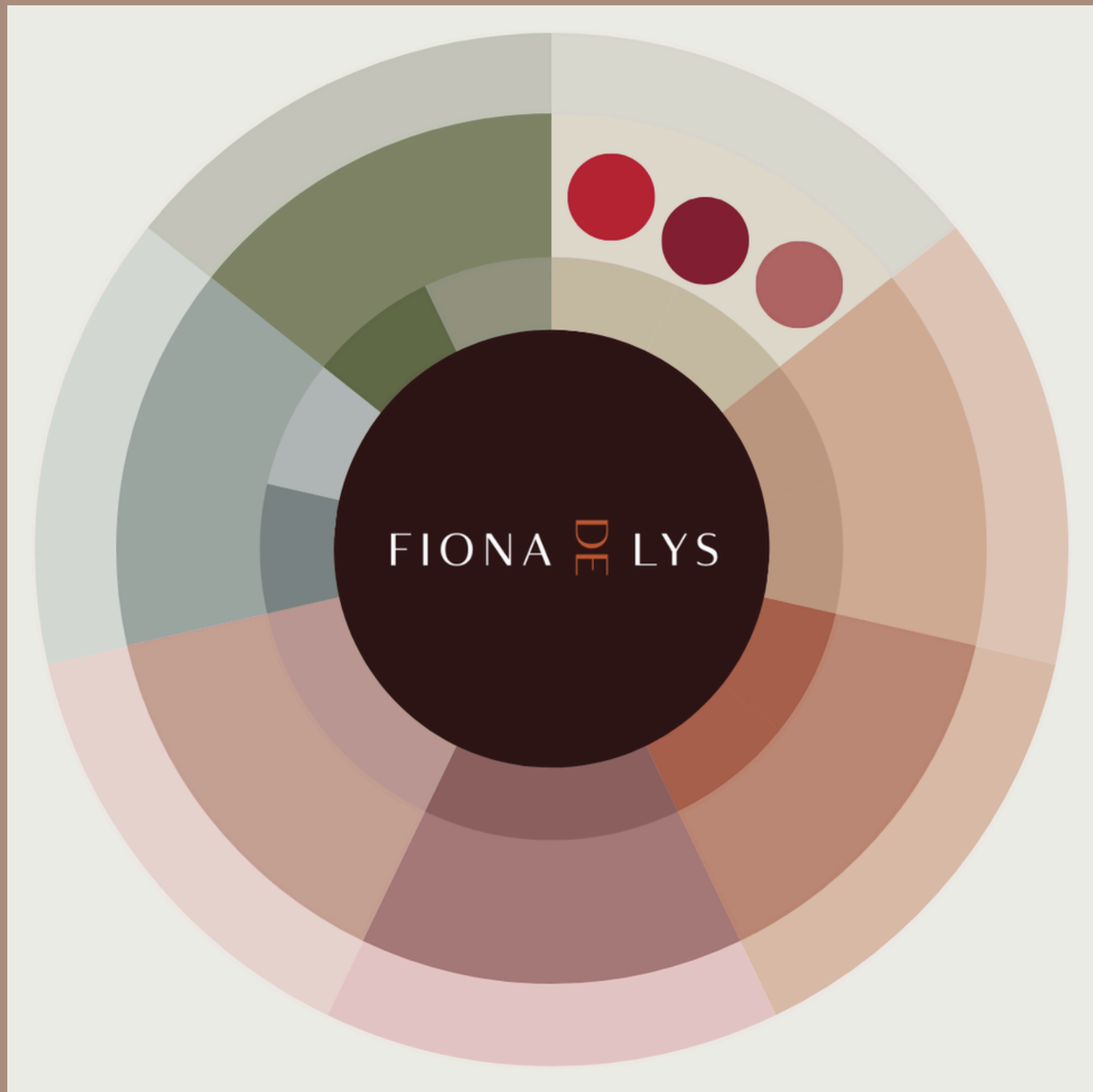

What to expect afterwards

Following our session together, you will receive a schedule itemising each room with the colours and finishes discussed for all surface areas. This is a helpful guide for you or your decorator when calculating paint quantities.

COMPLIMENTARY:

- ★ **A BESPOKE COLOUR WHEEL OF YOUR NEW COLOURS**
- ★ **MY 'GOOD PAINT PRACTICE' GUIDE**
- ★ **DISCOUNTS ON YOUR PAINT***

* discounts depend on availability and vary per brand.



Styling direction

Complement your colour scheme with additional help and advice on interior styling.



SOME PRESS

HOMES & GARDENS

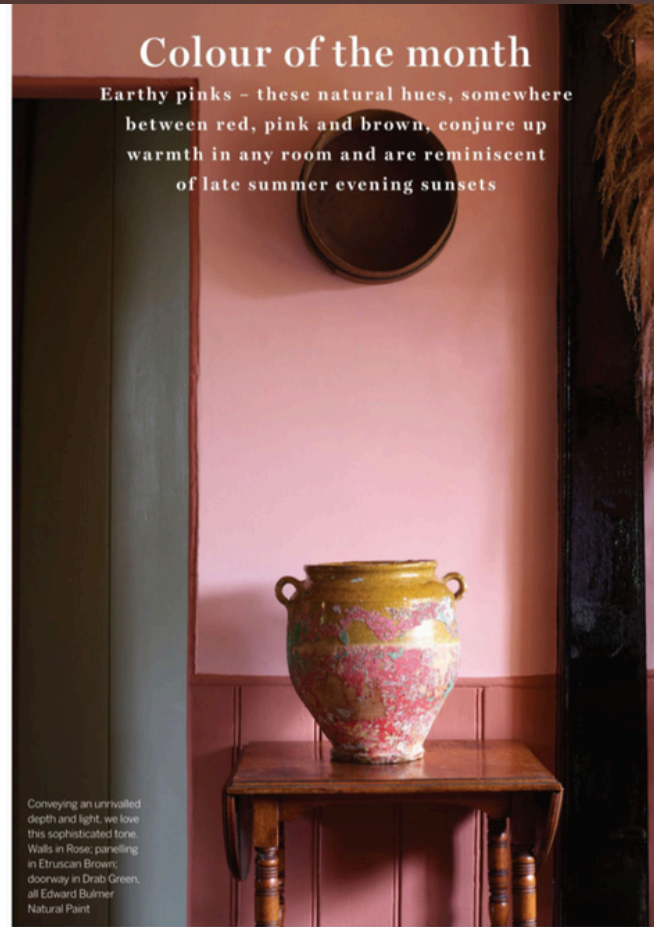

Colour of the month
Earthy pinks - these natural hues, somewhere between red, pink and brown, conjure up warmth in any room and are reminiscent of late summer evening sunsets

Check out this month's Homes & Gardens magazine to see styling for Colour of the month by Fiona de Lys, colour consultant for Edward Bulmer Natural Paint.

marie claire

2024

HOUSE & GARDEN

Some press.

HOUSES DECORATION GARDENS RECIPES TRAVEL

HOUSES

Colour consultant Fiona de Lys' magical north London cottage

Narrative is everything for stylist and colour consultant Fiona de Lys, whose atmospheric 18th-century north London has been intuitively

Features Brands Pricing Reports Journal

PORTAIRE

Diving Deep Into Colour Consulting With Fiona De Lys



www.fionadelys.co.uk

Login

Sign up

HEMETHORTHY

VINTAGE VIBES

Inside Color Consultant Fiona de Lys' London Cottage

Color consultant Fiona de Lys takes us inside her eclectic and beautifully layered Georgian cottage in London.

Steeped in history, Fiona embarked on a rejuvenating renovation of her 18th century Georgian cottage. With a passion for storytelling through design, Fiona's home not only perfects the art of balancing rugged charm with refined elegance, but also effortlessly reflects her English and Italian heritage.

In Fiona's sitting room, the verdant hues of English woodlands come to life, casting a tranquil spell on visitors. Rich, solid greens evoke the dappled sunlight filtering through leaves, fostering a deep connection to nature. Meanwhile, the dining room transports guests to Fiona's cherished childhood summers in Sardinia and Liguria, where terracotta and pinky orange tones pay homage to Mediterranean landscapes and family memories.

Throughout the home, Fiona's expertise as a color specialist shines, effortlessly harmonizing drama with simplicity. Every room unfolds like a chapter in a captivating novel, where art and antiques mingle to create a timeless and deeply personal atmosphere. Enjoy!

Some testimonials.

CHANTAL GELB

“We were thrilled with Fiona’s service. She unlocked our aesthetic narrative and guided us toward a palette of colours we wouldn’t have had the confidence to choose, and we absolutely love it. She brings an innate perceptiveness, attention to detail and understanding of colour, with extensive knowhow and experience.”

RACHAEL SMITH PHOTOGRAPHY

“Fiona really gets the essence of the home she’s in. I have worked with her on several magazine shoots and each one has been an absolute pleasure. A calm, fabulous stylist who adds the finishing touches perfectly. She is an absolute gem!”

JOSEPHINE CORBETT

“Joy. Thank you so much for today. It really was such a treat for me and I feel so excited getting it all done! All so exciting. Thank you.”

“Fiona is a marvel. Her colours come together in a beautiful symphony. She really takes the time to consider the narrative of a home and its inhabitants to conjure a beautiful palette fit for their story. We had such a fun morning building the layers; it was a treat to see it all come together under her expert eye.”

DAVINA, CLIENT OF EDWARD BULMER NATURAL PAINT

“Her knowledge of colours and how they work in a room was astounding and beyond helpful. We love the selection she’s made and are really looking forward to the paint cards, as well as starting the paint job.”

JO ELLIOT

“Within an hour of arriving at the house, Fiona had analysed the structural detailing and lighting plan of our cottage. After listening patiently to my haphazard thoughts, she helped plan the entire paint scheme brilliantly, whilst considering how colours respond to light throughout the morning. I was thrilled with her choices. Her help was invaluable.”



Fees – inc. travel within Greater London

£35/£65/£125



Zoom

30/60/120 MINUTES

From bite-size advice to longer sessions online, bring colour consultancy straight into your home.

£245/up to 2hrs



Basic

1-2 BED HOME

Ideal for homes with up to 6 areas; typically bedrooms, bathroom, hallway, kitchen, dining/living room.

£345/up to 3 hrs



Standard

3 BED HOME

Ideal for homes with up to 9 areas; typically bedrooms, office, bathrooms, hallway, kitchen, dining/living room.

From £400/From 4 hrs+



Premium

LARGER HOMES

Ideal for homes with 10+ areas; typically bedrooms, office, bathrooms, hallway, kitchen, dining/living room.



Contact

 fiona@fionadelys.co.uk

 [fionadelys_colourconsultant](https://www.instagram.com/fionadelys_colourconsultant)

 +44 (0)7443429614

 www.fionadelys.co.uk

 [Fiona de Lys](https://www.linkedin.com/in/Fiona de Lys)

 London | UK | Online | International



THANK YOU!

2024



Thank you for your enquiry. I'd love to help you on your colour journey!

FIONA DELLYS